

11587

## 88-91 HONDA CIVIC

3/25/2010

GROSS LOAD CAPACITY WHEN USED AS A WEIGHT CARRYING HITCH: 1,000 LBS. TRAILER WEIGHT &amp; 100 LBS. TONGUE WEIGHT.

\*\*\*DO NOT EXCEED VEHICLE MANUFACTURER'S RECOMMENDED TOWING CAPACITY.\*\*\*

**WARNING: ALL NON-TRAILER LOADS APPLIED TO THIS PRODUCT MUST BE SUPPORTED BY 18050 STABILIZING STRAPS.**

\*\* FAILURE TO PROPERLY SUPPORT NON-TRAILER LOADS WILL VOID PRODUCT WARRANTY\*\*

**HAVING INSTALLATION QUESTIONS? CALL TECHNICAL SUPPORT AT 1-800-798-0813**

Parts List				
ITEM	QTY	PART NUMBER	DESCRIPTION	
1	2	3/8-16 X 1 1/2	HEX BOLT	
2	6	3/8"	WASHER	
3	8	3/8"	LOCK WASHER	
4	8	3/8 - 16	HEX NUT	
5	6	3/8 - 16 x 1 1/4	HEX BOLT	
6	4	3/8"	FENDER WASHER	
7	1	CM-11587-RB	.375" REINFORCEMENT BAR	

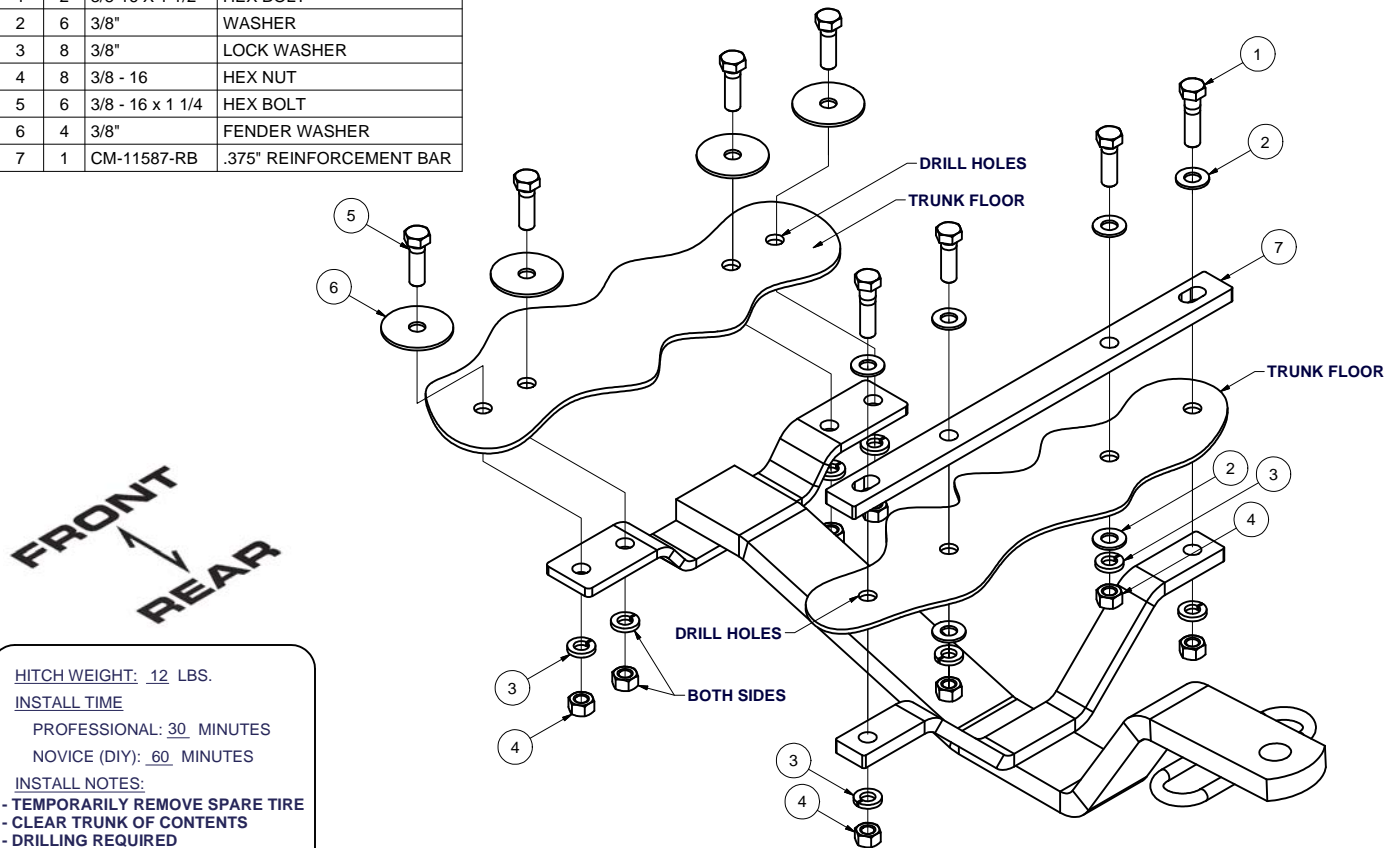

HITCH WEIGHT: 12 LBS.

INSTALL TIME

PROFESSIONAL: 30 MINUTES

NOVICE (DIY): 60 MINUTES

INSTALL NOTES:

- TEMPORARILY REMOVE SPARE TIRE
- CLEAR TRUNK OF CONTENTS
- DRILLING REQUIRED
- SILICONE AROUND FASTENERS

**INSTALLATION STEPS**

1. Remove the vehicle's spare tire and other contents. This hitch fastens to vehicle trunk floor with trunk reinforcement bar (CM-11587-RB) placed inside the trunk. Locate and mark centerline across vehicle at underside of trunk.
2. Position the hitch on underside of floor centered with the vehicle. The hitch should fit fore-aft on the vehicle so the trunk reinforcement aligns with rear bracket and "sandwiches" floor with reinforcement bar (CM-11587-RB) close to the rear of the trunk.
3. Use the hitch a template mark and centerpunch floor for (8) holes for 3/8" fasteners.
4. Install hitch with reinforcement bar (CM-11587-RB) and fender washers inside the trunk as shown.
5. Torque all 3/8" fasteners to 30 lb-ft.
6. Use silicone sealant around fasteners to seal out water and exhaust vapors.
7. Re-install spare tire and trunk contents.

PERIODICALLY CHECK THIS RECEIVER HITCH TO ENSURE THAT ALL FASTENERS ARE TIGHT AND THAT ALL STRUCTURAL COMPONENTS ARE SOUND.

Curt Manufacturing Inc., warrants this product to be free of defects in material and/or workmanship at the time of retail purchase by the original purchaser. If the product is found to be defective, Curt Manufacturing Inc., may repair or replace the product, at their option, when the product is returned, prepaid, with proof of purchase. Alteration to, misuse of, or improper installation of this product voids the warranty. Curt Manufacturing Inc.'s liability is limited to repair or replacement of products found to be defective, and specifically excludes liability for incidental or consequential loss or damage.