

**SPORT FRAME®****INSTALLATION INSTRUCTIONS****EQUIPMENT REQUIRED:****DRILL BITS:** 1/2", 1" HOLE SAW**WRENCHES:** (TIGHTEN ALL FASTENERS WITH TORQUE WRENCH) 3/4, 9/16

2000 LB MAX GROSS TRAILER WT  
200 LB MAX TONGUE WEIGHT  
DO NOT EXCEED TOWING VEHICLE RATINGS

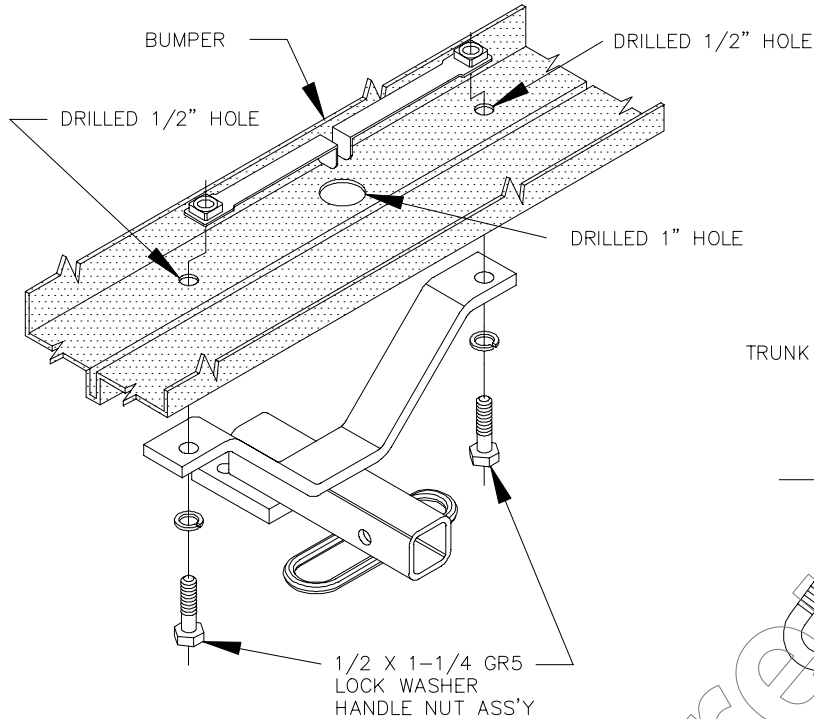

FIGURE 1

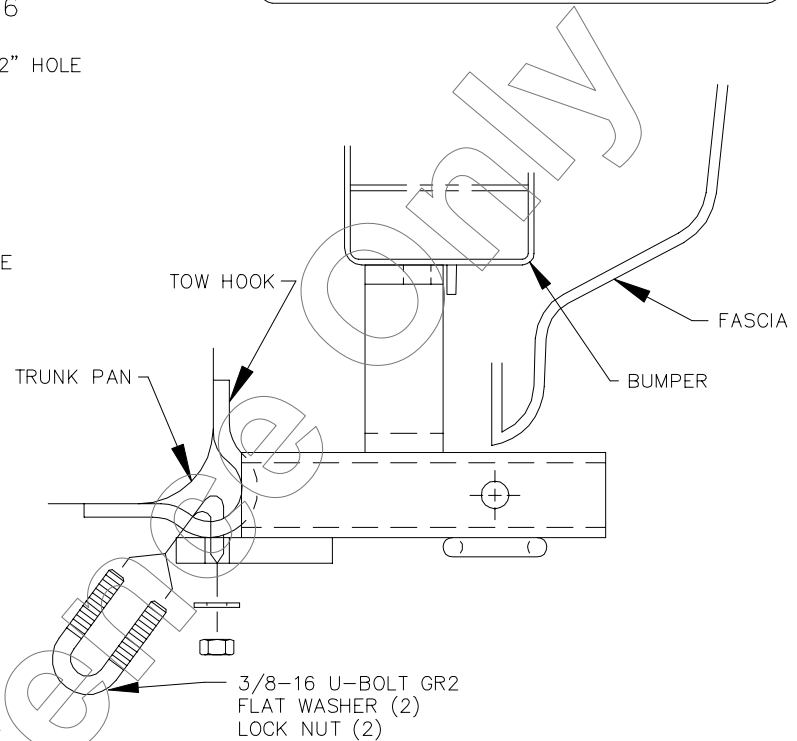
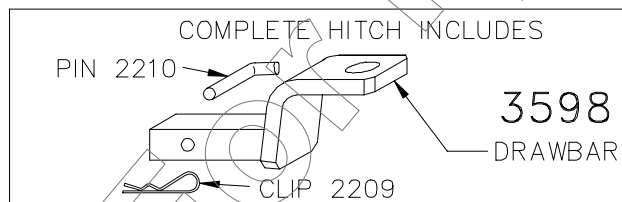

FIGURE 2

1. RAISE HITCH INTO POSITION CENTERED ON VEHICLE, SLIDING HITCH FORWARD ON VEHICLE UNTIL RECEIVER TUBE CONTACTS TOW HOOK (SEE FIGURE 2).
2. WITH HITCH IN POSITION, MARK LOCATIONS OF HOLES IN HITCH SADDLE BAR ON VEHICLE BUMPER. LOWER HITCH.
3. DRILL 1/2" HOLES IN VEHICLE BUMPER AT LOCATIONS MARKED IN STEP 2.
4. DRILL 1" HOLE IN VEHICLE BUMPER BETWEEN THE TWO (2) 1/2" HOLES.
5. RAISE HITCH BACK INTO POSITION AND INSTALL 1/2" FASTENERS (SEE FIGURE 1).
6. INSTALL 3/8" U-BOLT THROUGH TOW HOOK AND HITCH (SEE FIGURE 2). FASTEN WITH FLAT WASHERS AND NUTS AS SHOWN, MAKING SURE FLAT WASHERS DO NOT OVERLAP.  
TIGHTEN 3/8 GR2 FASTENERS TO 20 LB.-FT.  
TIGHTEN 1/2 GR5 FASTENERS TO 75 LB.-FT.

DRAWBAR REPLACEMENT KIT  
(INCLUDES PIN & CLIP)**3593**

NOTE: REPLACEMENT DRAWBAR AVAILABLE ONLY IN KIT. PINS &amp; CLIPS AVAILABLE SEPARATELY.

USE ONLY THE DRAWBAR SHOWN FOR CORRECT BUMPER CLEARANCE AND HEIGHT.  
DRAWBAR MUST BE USED IN THE RISE POSITION ONLY.

REMOVE DRAWBAR WHEN NOT TOWING  
TO PROTECT DRAWBAR OPENING IN HITCH WHEN NOT TOWING,  
INSERT COVER #2211 (PURCHASED SEPARATELY).

THIS PRODUCT COMPLIES WITH SAFETY SPECIFICATIONS AND REQUIREMENTS FOR CONNECTING DEVICES AND TOWING SYSTEMS OF THE STATE OF NEW YORK AND V.E.S.C. REGULATION V-5.

APPROX WEIGHT (LB.)

6.5

FASTENER KIT NO.

1130-928

NOTE: Check hitch frequently, making sure all fasteners and ball are properly tightened. If hitch is removed, plug all holes in trunk pan or other body panels to prevent entry of water and exhaust fumes. A hitch or ball which has been damaged should be removed and replaced. Observe safety precautions when working beneath a vehicle and wear eye protection. Follow car maker's specs for maximum trailer weight and tongue weight. Do not cut access or attachment holes with a torch.

**DRAW-TITE®**  
Canton, Michigan