

SPORT FRAME[®]
INSTALLATION INSTRUCTIONS

VEHICLE	HITCH NO.
MITSUBISHI MIRAGE 2 & 4 DR. DODGE COLT 2 & 4 DR. PLYMOUTH COLT 2 & 4 DR. EAGLE SUMMIT 2 & 4 DR.	24652

EQUIPMENT REQUIRED:

DRILL BITS: 1/2", 1" HOLE SAW

WRENCHES: (TIGHTEN ALL FASTENERS WITH TORQUE WRENCH) 1/2", 3/8"

2000 LB MAX GROSS TRAILER WT
200 LB MAX TONGUE WEIGHT
DO NOT EXCEED TOWING VEHICLE RATINGS

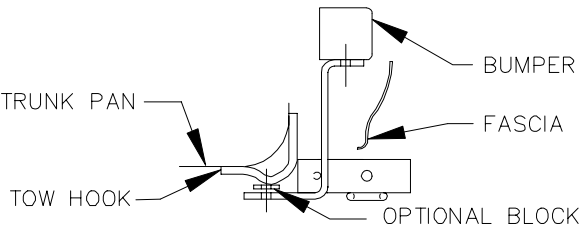

HITCH SHOWN IN PROPER POSITION

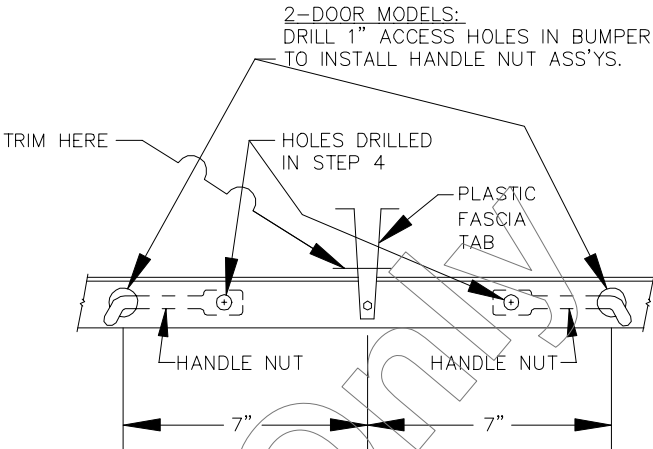

FIGURE 2
2-DOOR MODELS ONLY
(BOTTOM OF BUMPER)

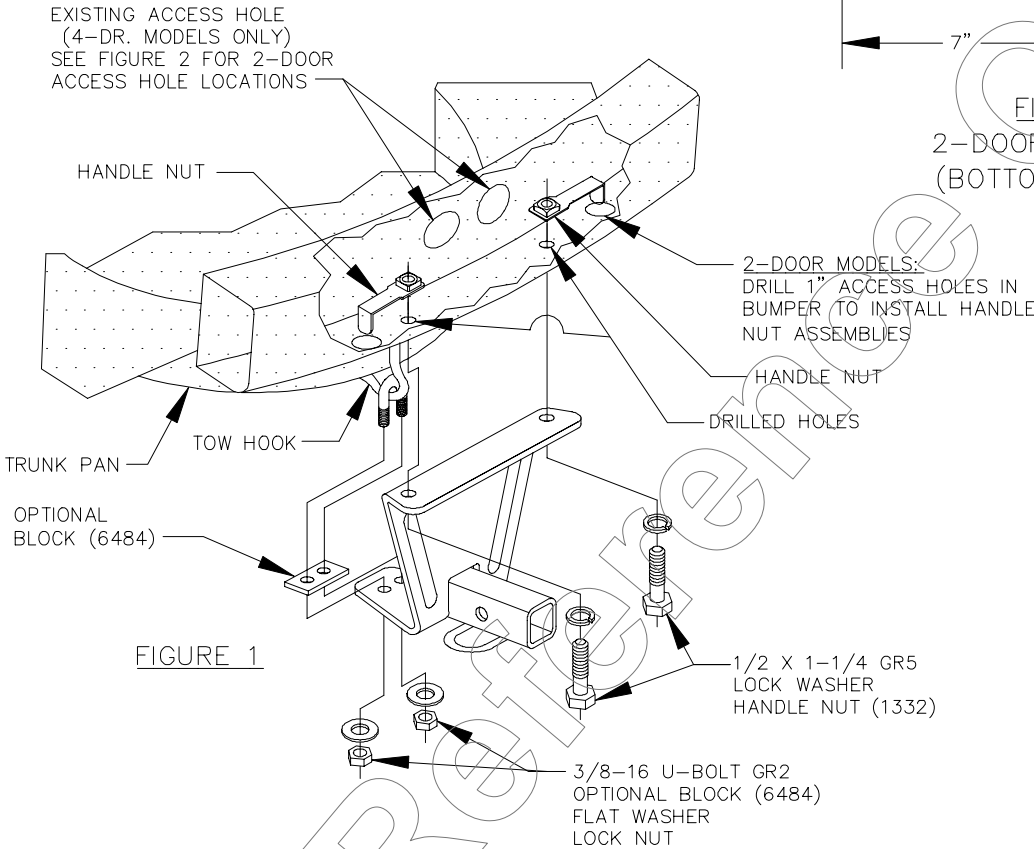

FIGURE 1

1. TRIM PLASTIC FASCIA TAB IF PRESENT. (FIGURE 2)
2. RAISE HITCH INTO POSITION CENTERED ON VEHICLE, SLIDING HITCH FORWARD ON VEHICLE UNTIL RECEIVER TUBE CONTACTS TOW HOOK.
3. WITH HITCH IN POSITION, MARK LOCATIONS OF HOLES IN HITCH BRACKET ON VEHICLE BUMPER, LOWER HITCH.
4. DRILL 1/2" HOLES IN VEHICLE BUMPER AT LOCATIONS MARKED IN STEP 3. ON 2-DOOR MODELS, DRILL TWO (2) 1" ACCESS HOLES AS SHOWN IN FIGURE 2.
5. RAISE HITCH BACK INTO POSITION. INSTALL 1/2" FASTENERS AS SHOWN IN FIGURE 1.
6. INSTALL 3/8" U-BOLT THROUGH TOW HOOK AND HITCH BRACKET AS SHOWN ABOVE. USE BLOCK (6484) IF NEEDED SO THAT RECEIVER IS LEVEL OR TILTED SLIGHTLY FORWARD. FASTEN WITH FLAT WASHERS AND NUTS AS SHOWN. MAKE SURE FLAT WASHERS DO NOT OVERLAP.

TIGHTEN 3/8 GR2 FASTENERS TO 20 LB.-FT.
TIGHTEN 1/2 GR5 FASTENERS TO 75 LB.-FT.

<p>COMPLETE HITCH INCLUDES</p> <p>PIN 2210</p> <p>CLIP 2209</p> <p>3598</p> <p>DRAWBAR</p>	<p>DRAWBAR REPLACEMENT KIT (INCLUDES PIN & CLIP)</p> <p>3593</p> <p>NOTE: REPLACEMENT DRAWBAR AVAILABLE ONLY IN KIT. PINS & CLIPS AVAILABLE SEPARATELY.</p>
---	--

USE ONLY THE DRAWBAR SHOWN FOR CORRECT BUMPER CLEARANCE AND HEIGHT.

REMOVE DRAWBAR WHEN NOT TOWING
TO PROTECT DRAWBAR OPENING IN HITCH WHEN NOT TOWING,
INSERT COVER #2211 (PURCHASED SEPARATELY).

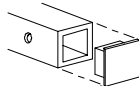

THIS PRODUCT COMPLIES WITH SAFETY SPECIFICATIONS AND REQUIREMENTS FOR CONNECTING DEVICES AND TOWING SYSTEMS OF THE STATE OF NEW YORK AND V.E.S.C. REGULATION V-5.

APPROX WEIGHT (LB.)	6.5	FASTENER KIT NO.	1131-011
---------------------	-----	------------------	----------

NOTE: Check hitch frequently, making sure all fasteners and ball are properly tightened. If hitch is removed, plug all holes in trunk pan or other body panels to prevent entry of water and exhaust fumes. A hitch or ball which has been damaged should be removed and replaced. Observe safety precautions when working beneath a vehicle and wear eye protection. Follow car maker's specs for maximum trailer weight and tongue weight. Do not cut access or attachment holes with a torch.