

INSTALLATION INSTRUCTIONS

VEHICLE

BUICK REGAL
PONTIAC GRAND PRIX GT & GTP

EQUIPMENT REQUIRED: FISHWIRE
WIRING ACCES LOCATION: PC3, PC4
DRILL BITS:
HITCH REQUIRES 1/2" PIN AND CLIP.
WRENCHES: (TIGHTEN ALL FASTENERS WITH TORQUE WRENCH) 9/16", 11/16", 7/8"

2000 LB MAX GROSS TRAILER WT
200 LB MAX TONGUE WEIGHT
DO NOT EXCEED TOWING VEHICLE RATINGS

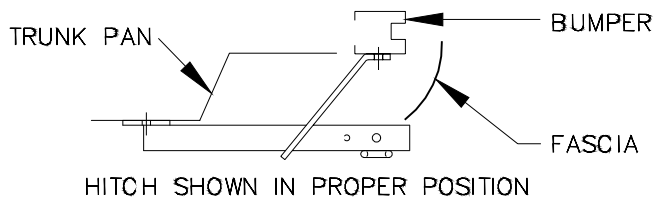

3/8-16 X 1-1/2 GR5 CARRIAGE BOLT
1/8 X 1 X 3 BLOCK
CONICAL TOOTHED WASHER
NUT

1/2-13 X 1-3/4 GR5 CARRIAGE BOLT
1/4 X 2-1/2 X 6 BAR
LOCK WASHER
NUT

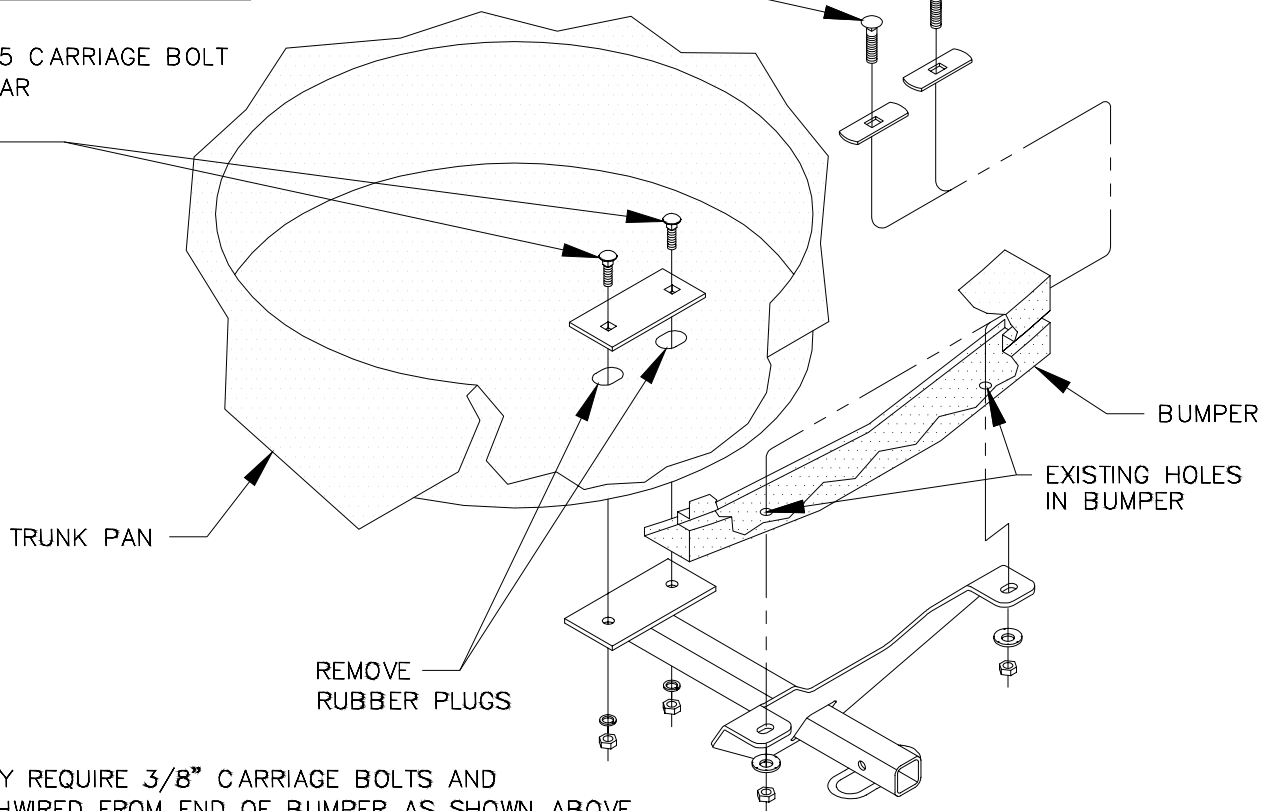

1. SOME BUMPERS MAY REQUIRE 3/8" CARRIAGE BOLTS AND BLOCKS TO BE FISHWIRED FROM END OF BUMPER AS SHOWN ABOVE.
2. REMOVE SPARE TIRE AND TRUNK PAN RUBBER PLUGS.
3. RAISE HITCH INTO POSITION AND ATTACH WITH FASTENERS AS SHOWN ABOVE.
4. SEAL HOLES IN TRUNK PAN TO PREVENT INTRUSION OF EXHAUST FUMES AND WATER.
5. REINSTALL SPARE TIRE.

TIGHTEN ALL 3/8" GR5 FASTENERS TO 31 LB.-FT.
TIGHTEN ALL 1/2" GR5 FASTENERS TO 75 LB.-FT.

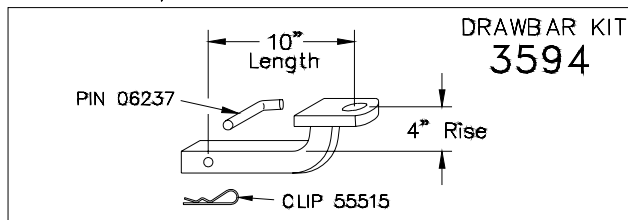

USE ONLY THE DRAWBAR SHOWN FOR CORRECT BUMPER CLEARANCE AND HEIGHT.
DRAWBAR MUST BE USED IN THE RISE POSITION ONLY.

THIS PRODUCT COMPLIES WITH SAFETY SPECIFICATIONS AND REQUIREMENTS FOR CONNECTING DEVICES AND TOWING SYSTEMS OF THE STATE OF NEW YORK, V.E.S.C. REGULATION V-5 AND SAE J684.

APPROX WEIGHT (LB.)	FASTENER KIT
14	01131-005

NOTE: Check hitch frequently, making sure all fasteners and ball are properly tightened. If hitch is removed, plug all holes in trunk pan or other body panels to prevent entry of water and exhaust fumes. A hitch or ball which has been damaged should be removed and replaced. Observe safety precautions when working beneath a vehicle and wear eye protection. Follow car maker's specs for maximum trailer weight and tongue weight. Do not cut access or attachment holes with a torch.

TOWING PRODUCTS
Plymouth, Michigan