

INSTALLATION INSTRUCTIONS

VEHICLE	HITCH NO.
HYUNDAI SONATA	24693

EQUIPMENT REQUIRED:
 WIRING ACCESS LOCATION: PC3, PC4
 DRILL BITS:

WRENCHES: (TIGHTEN ALL FASTENERS WITH TORQUE WRENCH) 9/16, 12mm, 14mm, 17mm

2000 LB MAX GROSS TRAILER WT
 200 LB MAX TONGUE WEIGHT
 DO NOT EXCEED TOWING VEHICLE RATINGS

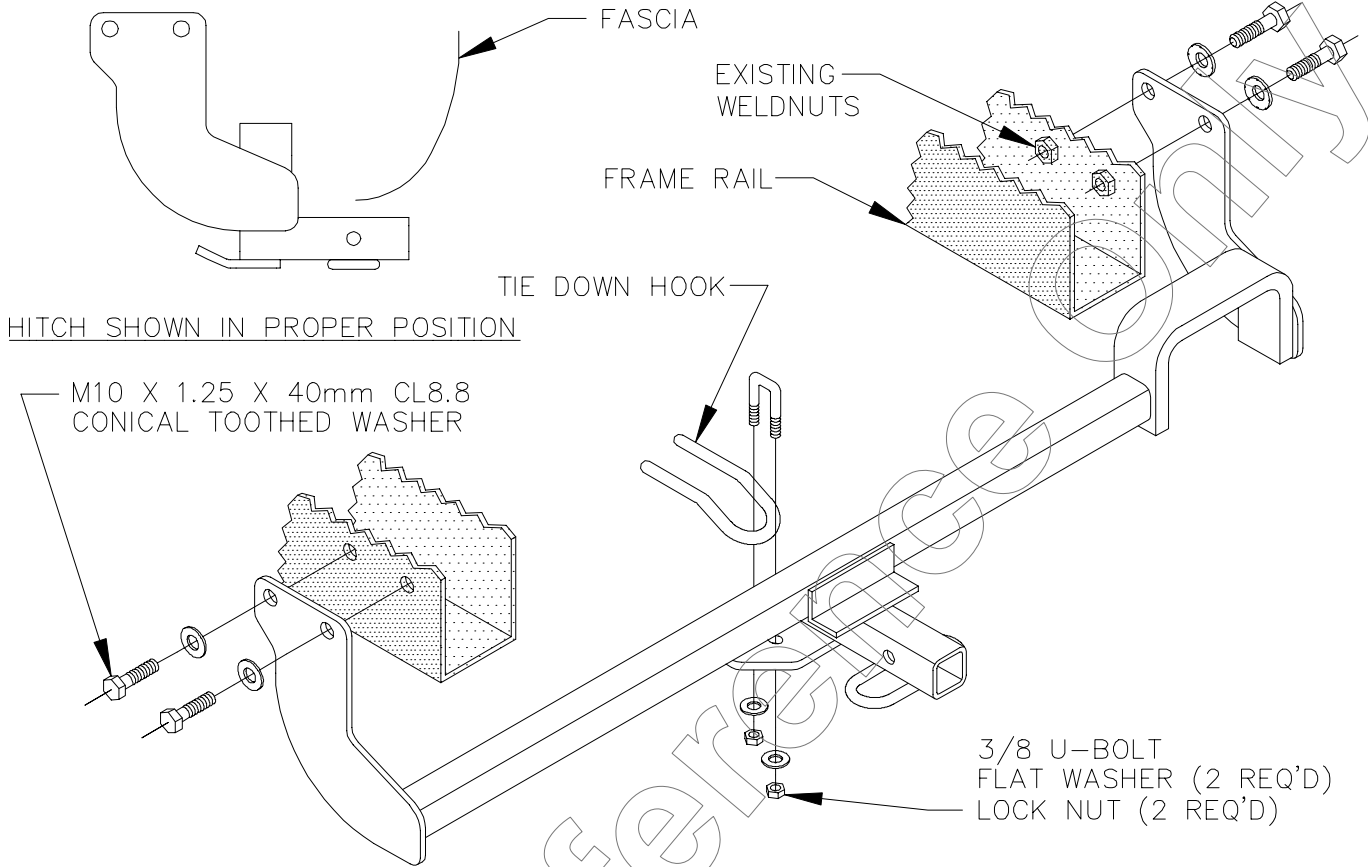

1. LOWER VEHICLE EXHAUST.
2. REMOVE EXISTING M10 FASTENERS FROM SIDE OF FRAME RAILS AND RETURN TO VEHICLE OWNER.
3. RAISE HITCH INTO POSITION AND ATTACH FASTENERS AS SHOWN ABOVE.
4. RAISE EXHAUST.

TIGHTEN ALL M10 CL8.8 FASTENERS TO 38 LB-FT.
 TIGHTEN ALL 3/8 GR2 FASTENERS TO 20 LB-FT.

<p>DESIGNED FOR USE WITH</p> <p>3598 DRAWBAR</p> <p>CLIP 2209</p>	<p>DRAWBAR REPLACEMENT KIT (INCLUDES PIN & CLIP)</p> <p>3593</p> <p>NOTE: REPLACEMENT DRAWBAR AVAILABLE ONLY IN KIT. PINS & CLIPS AVAILABLE SEPARATELY.</p>
------------------------------------------------------------------------------	--------------------------------------------------------------------------------------------------------------------------------------------------------------------------------

USE ONLY THE DRAWBAR SHOWN FOR CORRECT BUMPER CLEARANCE AND HEIGHT.
 DRAWBAR MUST BE USED IN THE RISE POSITION ONLY.

REMOVE DRAWBAR WHEN NOT TOWING
 TO PROTECT DRAWBAR OPENING IN HITCH WHEN NOT TOWING,
 INSERT COVER #2211 (PURCHASED SEPARATELY).

THIS PRODUCT COMPLIES WITH SAFETY SPECIFICATIONS AND REQUIREMENTS FOR CONNECTING DEVICES AND TOWING SYSTEMS OF THE STATE OF NEW YORK AND V.E.S.C. REGULATION V-5.

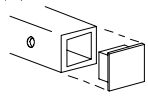

APPROX WEIGHT (LB.)	24	FASTENER KIT NO.	F24693
---------------------	----	------------------	--------

NOTE: Check hitch frequently, making sure all fasteners and ball are properly tightened. If hitch is removed, plug all holes in trunk pan or other body panels to prevent entry of water and exhaust fumes. A hitch or ball which has been damaged should be removed and replaced. Observe safety precautions when working beneath a vehicle and wear eye protection. Follow car maker's specs for maximum trailer weight and tongue weight. Do not cut access or attachment holes with a torch.

