

INSTALLATION INSTRUCTIONS

VEHICLE	HITCH NO.
DODGE GRAND CARAVAN DODGE CARAVAN C/V PLYMOUTH GRAND VOYAGER	36143

EQUIPMENT REQUIRED:
WIRING ACCESS LOCATION: SUV1, SUV2
DRILL BITS: NONE – ALL EXISTING HOLES

WRENCHES: (TIGHTEN ALL FASTENERS WITH TORQUE WRENCH) 11/16, 7/8

3500 LB MAX GROSS TRAILER WT
 300 LB MAX TONGUE WEIGHT
 DO NOT EXCEED TOWING VEHICLE RATINGS

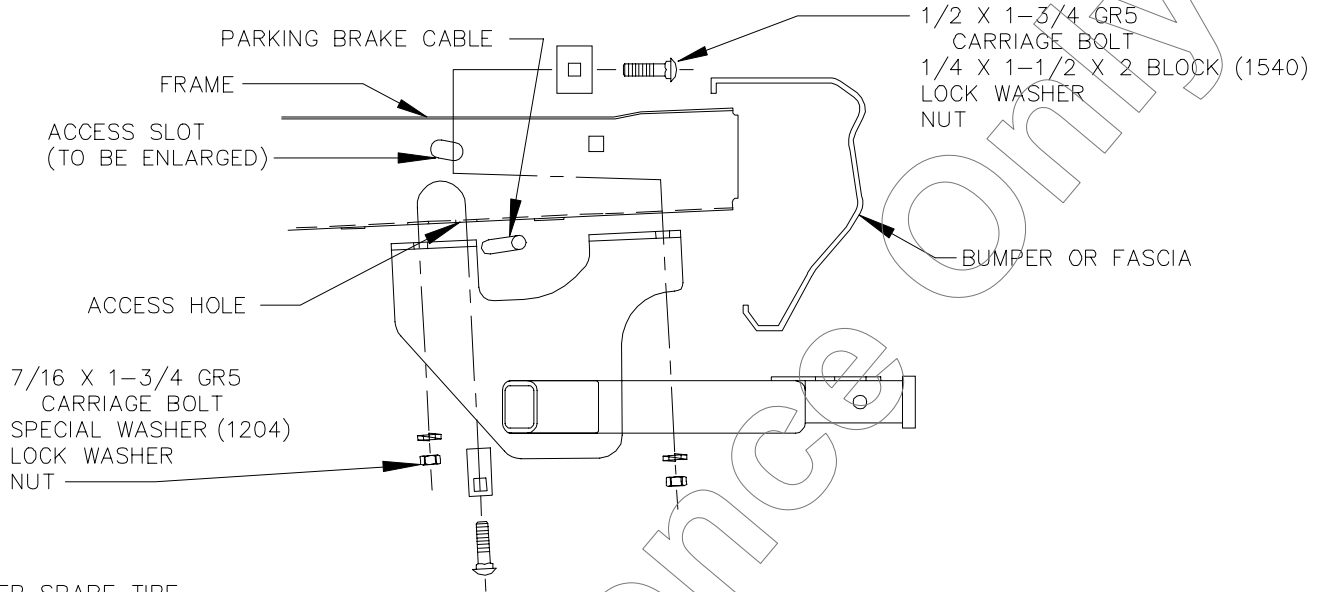

1. LOWER SPARE TIRE.
2. ENLARGE THE 1-1/4" LONG X 3/4" WIDE ACCESS SLOT ON THE SIDE OF THE FRAME RAIL TO ACCEPT A 1-1/2" WIDE BLOCK (1540) AND 1/2" CARRIAGE BOLT.
3. USING ACCESS SLOT, INDIVIDUALLY FISHWIRE BLOCK AND 1/2" CARRIAGE BOLT INTO THE EXISTING HOLES AT THE END OF THE FRAME.
4. USE ACCESS HOLE IN BOTTOM OF FRAME TO FISHWIRE 7/16" CARRIAGE BOLT, AND SPECIAL WASHER (1204) INTO FORWARD HOLES.
5. RAISE HITCH INTO POSITION, BEING CAREFUL NOT TO PUSH FASTENERS BACK INTO THE FRAME. INSTALL LOCK WASHERS AND NUTS.
6. RAISE SPARE TIRE BACK INTO POSITION. DO NOT CONTACT BRAKE CABLE WITH SPARE TIRE. SPARE TIRE MAY TOUCH CROSSTUBE.

TIGHTEN 7/16 GR5 FASTENERS TO 50 LB.-FT.
 TIGHTEN 1/2 GR5 FASTENERS TO 75 LB.-FT.

<p>COMPLETE HITCH INCLUDES</p>	DRAWBAR REPLACEMENT KIT (INCLUDES PIN & CLIP) 36071 ZINC 36072 CHROME
	NOTE: REPLACEMENT DRAWBAR AVAILABLE ONLY IN KIT. PINS & CLIPS AVAILABLE SEPARATELY.

USE ONLY THE DRAWBAR SHOWN FOR CORRECT BUMPER CLEARANCE AND HEIGHT.
 REMOVE DRAWBAR WHEN NOT TOWING
 TO PROTECT DRAWBAR OPENING IN HITCH WHEN NOT TOWING,
 INSERT COVER #2211 (PURCHASED SEPARATELY).

THIS PRODUCT COMPLIES WITH SAFETY SPECIFICATIONS AND REQUIREMENTS FOR CONNECTING DEVICES AND TOWING SYSTEMS OF THE STATE OF NEW YORK AND V.E.S.C. REGULATION V-5.

APPROX WEIGHT (LB.)	28.5	FASTENER KIT NO.	F36143
---------------------	------	------------------	--------

NOTE: Check hitch frequently, making sure all fasteners and ball are properly tightened. If hitch is removed, plug all holes in trunk pan or other body panels to prevent entry of water and exhaust fumes. A hitch or ball which has been damaged should be removed and replaced. Observe safety precautions when working beneath a vehicle and wear eye protection. Follow car maker's specs for maximum trailer weight and tongue weight. Do not cut access or attachment holes with a torch.

