

# INSTALLATION INSTRUCTIONS

**DO NOT EXCEED PRODUCT RATING OR TOW VEHICLE LAMP LOAD RATING, WHICHEVER IS LOWER**

## 56267 APPLICATIONS

Make	Model
Nissan	Murano

## VEHICLE-TO-TRAILER WIRING HARNESS

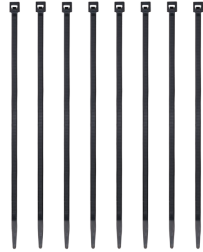
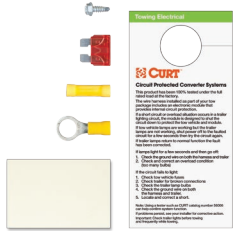
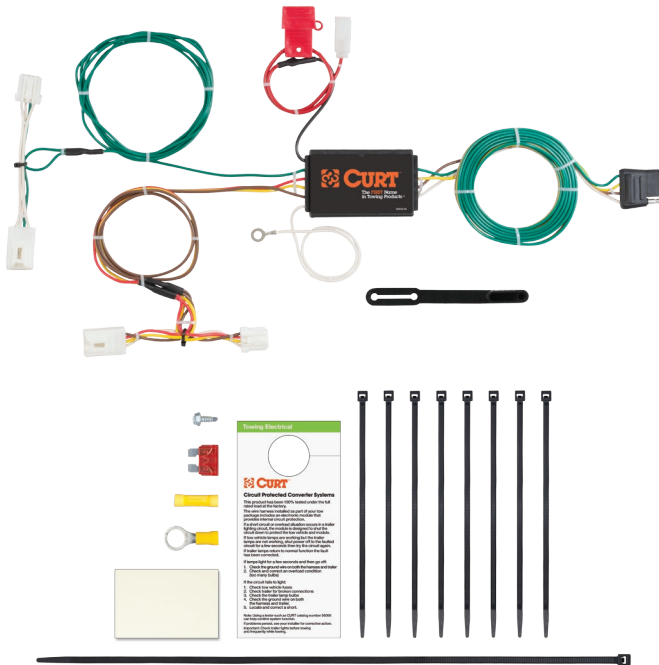

## WIRING LOCATION GUIDE

### SUVS, MINI & FULL-SIZED VANS (S)

Representative vehicle shown below

- S3 - Behind driver side rear access panel
- S4 - Behind passenger side rear access panel
- S8 - Under rear floor panel



## NOTE

All steps must be followed to ensure the CURT wiring harness will function properly. Once installed, test for proper function by using a test light or connecting a properly wired trailer.

## TOOLS NEEDED

- 10mm socket
- Ratchet

## WARNING

The battery connection must be fuse protected, 10 amp max. Exceeding the product rating can cause loss of warranty, overheating and potential fire. Do not exceed product rating or tow vehicle lamp load rating, whichever is lower.

- Signal Circuits - 3.0 amps per side
- Tail / Running Circuits - 6.0 amps total

Check vehicle owner's manual or contact the vehicle manufacturer for more information.

# INSTALLATION

## Step 1

Locate vehicle battery on the driver side under the hood and disconnect the negative battery terminal (A).

## Step 2

Open the vehicle tailgate and remove both side floor coverings (B,C). Lift the center floor cover up and secure it out of the way.

## Step 3

Lift center floor cover up and latch out of the way.

## Step 4

Starting on the driver side, remove the two 10mm fasteners from the plastic storage tray and remove it (D,E).

## Step 5

Behind the removed plastic storage tray locate the vehicle taillight wiring harness connectors (F). The connectors will be similar to those on the CURT wiring harness. Separate the connectors from the taillight housing taking care not to damage the locking tabs.

## Step 6

Insert the CURT wiring harness end with yellow wire between the separated connectors. Make sure the connectors are fully inserted with locking tabs in place (G).

**WARNING:** Check for miscellaneous items that may be hidden behind or under any surface before drilling to avoid damage and / or personal injury.

## Step 7

Locate a suitable grounding point near the connector such as an existing screw with nut in the vehicle frame or drill a 3/32" pilot hole for the provided screw. The area should be free of rust, dirt and paint. Secure the white ground wire using the ring terminal and provided screw.

## Step 8

Route the CURT wiring harness end with the green wire to the passenger side under the scuff panel. Repeat steps 4-6 on the passenger side using the harness end with the green wire.

## Step 9

On the driver side of the vehicle, along the existing factory wiring harness, locate the single pin connector. It will mate with the connector on the black power wire. Insert the connector into the vehicle connector. Make sure the connector is fully inserted with locking tabs in place (H).

## Step 10

Locate a flat spot inside the vehicle, near the taillight. Adhere the black converter box using the provided double-sided tape.

## Step 11

Install 10 amp fuse into the red fuse holder on the wire harness.

## Step 12

Under the hood, locate the vehicle fuse box (I). Remove the fuse panel cover and locate the trailer tow fuse. Reference the back of the fuse cover for position and location. If the position is empty, insert the provided 10 amp fuse into that fuse location.

## Step 13

When in use, route the 4-flat to the center of the vehicle and out of the trunk. When not in use, roll up and store in a convenient, out of the way location inside the trunk. Secure any loose wires with the provided cable ties.

## Step 14

Reinstall all items removed during install and reconnect negative battery terminal. Install the provided 4-flat dust cover to help prevent corrosion.

