

INSTALLATION INSTRUCTIONS

⚠ WARNING: DO NOT EXCEED PRODUCT RATING OR TOW VEHICLE LAMP LOAD RATING, WHICHEVER IS LOWER

56315 APPLICATIONS

Make	Model
Chevrolet	Volt

WIRING LOCATION GUIDE

PASSENGER CARS (P)

Representative vehicle shown below

P1 - Behind driver side taillight housing, outside of trunk

P2 - Behind passenger side taillight housing, outside of trunk

VEHICLE-TO-TRAILER WIRING HARNESS

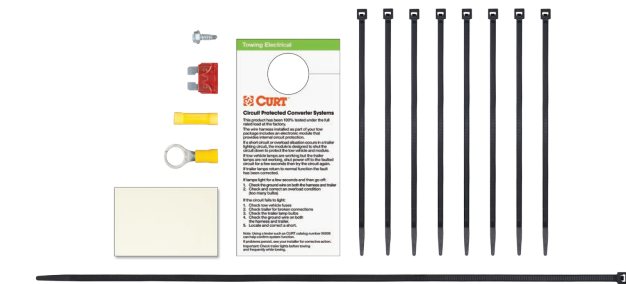

NOTICE

All steps must be followed to ensure the CURT wiring harness will function properly. Once installed, test for proper function by using a test light or connecting a properly wired trailer.

TOOLS NEEDED

- 10mm socket
- Ratchet
- Panel trim removal tool
- Phillips screwdriver
- T-15 Torx bit
- Side cutter
- Cutting tool

⚠ WARNING

The battery connection must be fuse protected, 10 amp max. Exceeding the product rating can cause loss of warranty, overheating and potential fire. Do not exceed product rating or tow vehicle lamp load rating, whichever is lower.

Signal Circuits - 3.0 amps per side
Tail / Running Circuits - 6.0 amps total

Check vehicle owner's manual or contact the vehicle manufacturer for more information.

INSTALLATION / SAFETY INSTRUCTIONS

- Step 1**
Locate vehicle battery on the driver side under the hood and disconnect the negative battery terminal.
- Step 2**
Open the vehicle trunk. Remove all trunk floor coverings (A). Remove the fasteners securing the trunk storage trays (B). Remove the trays (C).
- Step 3**
Remove the scuff panel by pulling out on the bottom and then up. Take care not to damage the alignment tabs on the back (D).
- Step 4**
Starting on the driver side, remove the fasteners securing the side felt liner in place (E). Pull back on the felt liner to allow access for routing the custom wiring harness (F).
- Step 5**
On the outside of the vehicle, remove the fasteners securing the taillights. Remove the taillights by gently pulling rearward and out on the taillight (G).
- Step 6**
Behind the taillight, locate the vehicle taillight wiring harness connectors (H). The connectors will be similar to those on the CURT wiring harness. Separate the connectors from the taillight housing taking care not to damage the locking tabs.

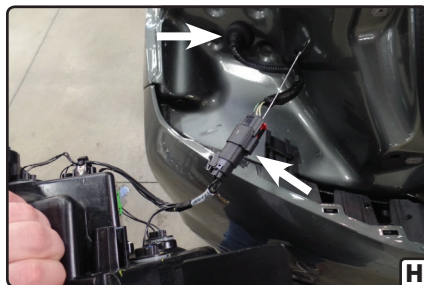
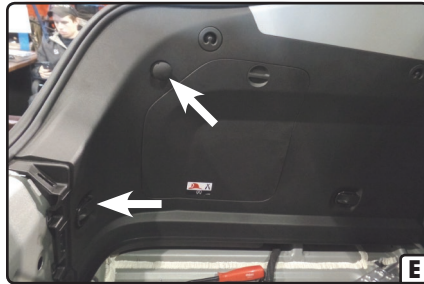
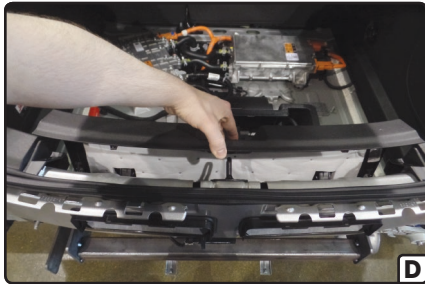

INSTALLATION / SAFETY INSTRUCTIONS

Step 7

Locate the grommet behind the taillight where the vehicle taillight wiring passes through from inside the cabin to the taillight (H). Remove the grommet and cut a slit large enough to route the CURT wiring harness through (I).

Step 8

Route the CURT wiring harness end with the yellow wire out through the grommet opening and through the slit in the grommet. Insert the CURT wiring harness end with yellow wire between the separated connectors. Make sure the connectors are fully inserted with locking tabs in place.

Step 9

Reseat the grommet and use sealant (not provided) to seal the cut in the grommet and around all the wires.

Step 10

Locate a suitable grounding point near the connector such as an existing screw with nut in the vehicle frame or drill a 3/32" pilot hole for the provided screw. The area should be free of rust, dirt and paint. Secure the white ground wire using the ring terminal and provided screw.

 **WARNING:** Check for miscellaneous items that may be hidden behind or under any surface before drilling to avoid damage and / or personal injury.

Step 11

Locate a flat spot inside the vehicle, near the taillight. Adhere the black converter box using the provided double-sided tape.

Step 12

Route the CURT wiring harness end with the green wire to the passenger side behind the removed scuff panel. Repeat steps 4-9 on the passenger side using the harness end with the green wire.

Step 13

Route the black power wire from the vehicle battery as shown on the included CME-PCL-INS sheet.

Step 14

When in use, route the 4-flat to the center of the vehicle. When not in use, roll up and store in a convenient, out of the way location. Secure any loose wires with the provided cable ties.

Step 15

Reinstall all items removed during install and reconnect negative battery terminal. Install the provided 4-flat dust cover to help prevent corrosion.

