

INSTALLATION INSTRUCTIONS

⚠ WARNING: DO NOT EXCEED PRODUCT RATING OR TOW VEHICLE LAMP LOAD RATING, WHICHEVER IS LOWER

56353 APPLICATIONS

Make	Model
Toyota	Prius

WIRING LOCATION GUIDE

PASSENGER CARS (P)

Representative vehicle shown below

- P3 - Behind driver side taillight housing, inside of trunk
- P4 - Behind passenger side taillight housing, inside of trunk
- P6 - Behind center of rear bumper

CUSTOM WIRING HARNESS

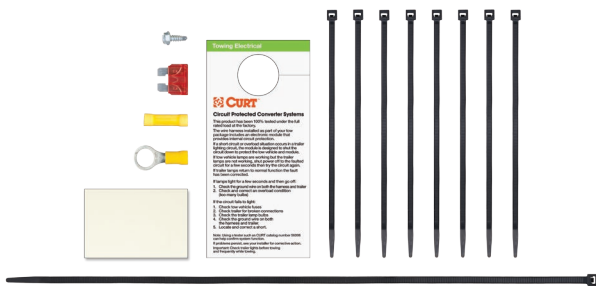
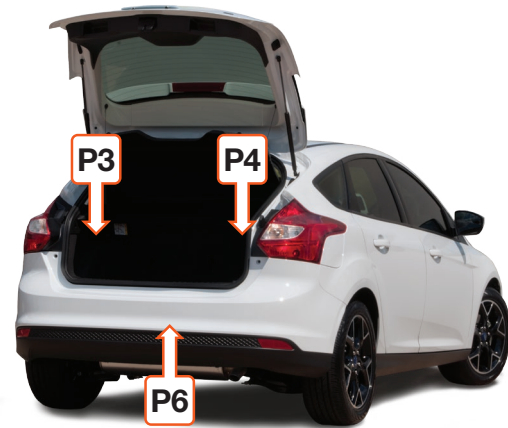

NOTICE

All steps must be followed to ensure the CURT wiring harness will function properly. Once installed, test for proper function by using a test light or connecting a properly wired trailer.

TOOLS NEEDED

- 10mm socket
- Ratchet
- Panel trim removal tool
- Flat blade screwdriver
- Wire stripper
- Crimping tool
- Cutting tool
- Grommet sealant (included)

⚠ WARNING

The battery connection must be fuse protected, 10 amp max. Exceeding the product rating can cause loss of warranty, overheating and potential fire. Do not exceed product rating or tow vehicle lamp load rating, whichever is lower.

Signal Circuits - 3.0 amps per side
Tail / Running Circuits - 6.0 amps total

Check vehicle owner's manual or contact the vehicle manufacturer for more information.

INSTALLATION / SAFETY INSTRUCTIONS

Step 1

Locate vehicle battery on the driver side under the hood and disconnect the negative battery terminal.

Step 2

Open the trunk. Remove all trunk floor coverings (A).

Step 3

Remove the fasteners holding the storage trays in place. Remove the trays (B). Use a flathead screwdriver to remove the rear fastener in the storage trays (C). Remove the front plastic hold down by using a trim panel removal tool and carefully prying upwards (D).

Step 4

Remove the fasteners securing the rear scuff panel (E). Remove the scuff panel by pulling out on the bottom and then up. Take care not to damage the alignment tabs on the back (F).

Step 5

Starting on the driver side, remove the fasteners and cargo tie downs securing the side trunk liner in place. Using a flathead screwdriver, locate the small slot on the tie down and press inwards to release the plastic tie down (G).

Step 6

Remove the two 10mm fasteners securing the upper plastic trim panel (H). Remove the panel.

Step 7

Pull back on the side trunk liner to locate the vehicle taillight wiring harness connectors. Take care not to damage the alignment tabs on the back. Separate the connector from the trunk light before pulling the side trunk liner all of the way out (I).

Step 8

Locate the vehicle taillight wiring harness connectors (J). The connectors will be similar to those on the CURT wiring harness. Separate the connectors from the taillight housing taking care not to damage the locking tabs (K).

Step 9

Insert the CURT wiring harness end with yellow wire between the separated connectors. Make sure the connectors are fully inserted with locking tabs in place.

Step 10

Locate a suitable grounding point near the connector such as an existing screw with nut in the vehicle frame or drill a 3/32" pilot hole for the provided screw. The area should be free of rust, dirt and paint. Secure the white ground wire using the ring terminal and provided screw.

 **WARNING:** Check for miscellaneous items that may be hidden behind or under any surface before drilling to avoid damage and / or personal injury.

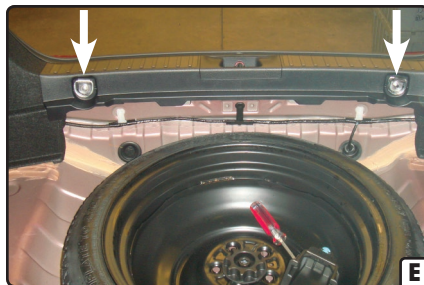
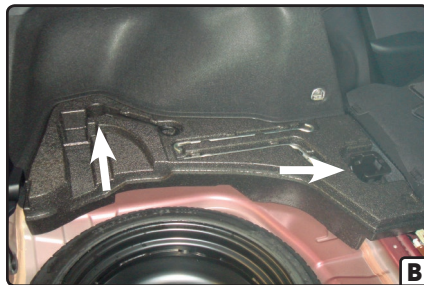

Step 11

On the outside of the vehicle, under the rear bumper, locate the center trim panel (L). Remove the fasteners holding the trim panel in place.

Step 12

Remove the center trim panel to locate the vehicle taillight connector (M). The connectors will be similar to those on the CURT wiring harness. Separate the connectors taking care not to damage the locking tabs.

Step 13

Locate the grommet behind the taillight where the vehicle taillight wiring passes through from inside the cabin to the taillight (N). Remove the grommet and cut a slit large enough to route the CURT wiring harness through (O).

Step 14

Route the CURT wiring harness ends with the brown and red wires out through the grommet opening and through the slit in the grommet. Insert the CURT wiring harness end with brown and red wire between the separated connectors. Make sure the connectors are fully inserted with locking tabs in place.

Step 15

Reseat the grommet using the provided sealant to seal the cut in the grommet and around all the wires.

Step 16

Locate a flat spot inside the vehicle, near the taillight. Adhere the black converter box using the provided double-sided tape.

Step 17

Route the CURT wiring harness end with the green wire to the passenger side behind the removed scuff panels. Repeat steps 5-9 on the passenger side using the harness end with the green wire.

Step 18

Route the black power wire from the vehicle battery as shown on the included CME-PCL-INS sheet.

Step 19

When in use, route the 4-flat to the center of the vehicle and out of the trunk. When not in use, roll up and store in a convenient, out of the way location inside the trunk. Secure any loose wires with the provided cable ties.

Step 20

Reinstall all items removed during install and reconnect negative battery terminal. Install the provided 4-flat dust cover to help prevent corrosion.

