

INSTALLATION INSTRUCTIONS

EQUIPMENT REQUIRED:

DRILL BITS: NONE

WRENCHES: (TIGHTEN ALL FASTENERS WITH TORQUE WRENCH) 3/4, 18mm, 19mm

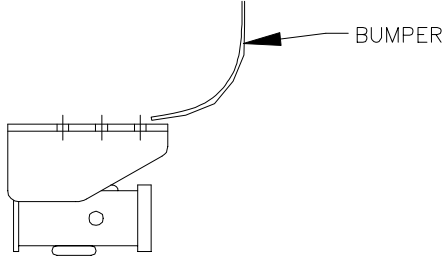

HITCH SHOWN INSTALLED IN
PROPER POSITION

VEHICLE
MITSUBISHI MONTERO

HITCH NO.
75057

VEHICLE EXHAUST (TAILPIPE) MUST
BE ALTERED FOR HITCH INSTALLATION.

DO NOT EXCEED LOWER OF
TOWING VEHICLE MFR'S RATINGS OR

HITCH TYPE ▼	MAX GROSS TRLR WT(LB)	MAX TONGUE WT(LB)
WEIGHT DISTRIBUTING	5500	550
WEIGHT CARRYING BALL MOUNT	5000	500

M12 X 1.25 X 35mm CL 8.8
CONICAL TOOTHED WASHER
EXISTING WELDNUT

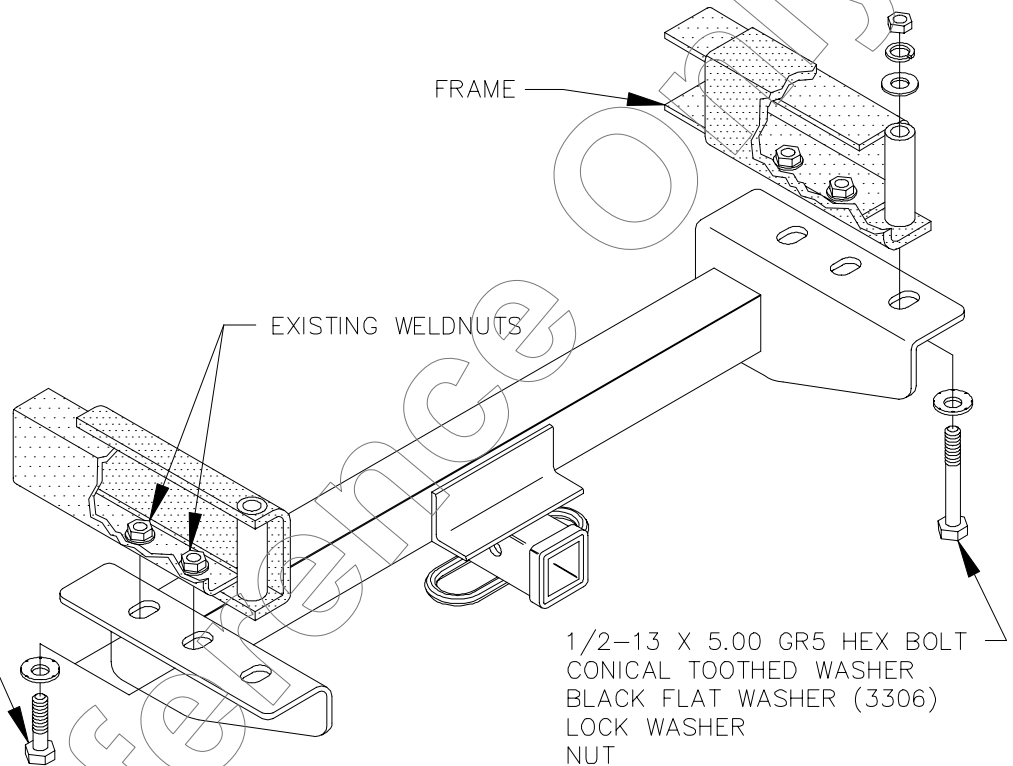

FIGURE 1
1994 AND LATER MODELS

94' AND LATER MODELS:

1. VEHICLE EXHAUST (TAILPIPE) MUST BE ALTERED FOR HITCH INSTALLATION, SEE PAGE 2.
2. RAISE HITCH INTO POSITION, LINING UP HOLES IN HITCH WITH EXISTING WELDNUTS IN VEHICLE FRAME.
3. INSTALL M12 BOLTS AND FASTENERS INTO EXISTING WELDNUTS AS SHOWN IN FIGURE 1, BOTH SIDES.
4. INSTALL 1/2 HEX BOLT AND FASTENERS THROUGH REARMOST ATTACHMENT AS SHOWN IN FIGURE 1, BOTH SIDES.

93' AND EARLIER MODELS:

1. VEHICLE EXHAUST (TAILPIPE) MUST BE ALTERED FOR HITCH INSTALLATION, SEE PAGE 2.
2. RAISE HITCH INTO POSITION, LINING UP HOLES IN HITCH WITH EXISTING HOLES IN VEHICLE FRAME.
3. INSTALL M12 BOLT AND FASTENERS INTO EXISTING WELDNUT AS SHOWN IN FIGURE 2, BOTH SIDES.
4. FISHWIRE 1/2 CARRIAGE BOLTS, BLOCK (3989), AND SMALL ZINC FLAT WASHER (USED AS SPACER) THROUGH END OF FRAME AS SHOWN IN FIGURE 2.
5. INSTALL REMAINING FASTENERS AS SHOWN.

TIGHTEN M12 CL 8.8 FASTENERS TO 68 LB.-FT.
TIGHTEN 1/2 GR5 FASTENERS TO 75 LB.-FT.

THIS PRODUCT COMPLIES WITH SAFETY SPECIFICATIONS AND REQUIREMENTS FOR CONNECTING DEVICES AND TOWING SYSTEMS OF THE STATE OF NEW YORK AND V.E.S.C. REGULATION V-5.

APPROX WEIGHT (LB.)

32

FASTENER KIT NO.

1131-079

NOTE: Check hitch frequently, making sure all fasteners and ball are properly tightened. If hitch is removed, plug all holes in trunk pan or other body panels to prevent entry of water and exhaust fumes. A hitch or ball which has been damaged should be removed and replaced. Observe safety precautions when working beneath a vehicle and wear eye protection. Follow car maker's specs for maximum trailer weight and tongue weight. Do not cut access or attachment holes with a torch.



Canton, Michigan

INSTALLATION INSTRUCTIONS

EQUIPMENT REQUIRED:

DRILL BITS: NONE

WRENCHES: (TIGHTEN ALL FASTENERS WITH TORQUE WRENCH) 3/4, 18mm, 19mm

VEHICLE
MITSUBISHI MONTEROHITCH NO.
75057VEHICLE EXHAUST (TAILPIPE) MUST
BE ALTERED FOR HITCH INSTALLATION.DO NOT EXCEED LOWER OF
TOWING VEHICLE MFR'S RATINGS OR

HITCH TYPE ▼	MAX GROSS TRLR WT(LB)	MAX TONGUE WT(LB)
WEIGHT DISTRIBUTING	5500	550
WEIGHT CARRYING BALL MOUNT	5000	500

FIGURE 2
1993 AND EARLIER MODELS

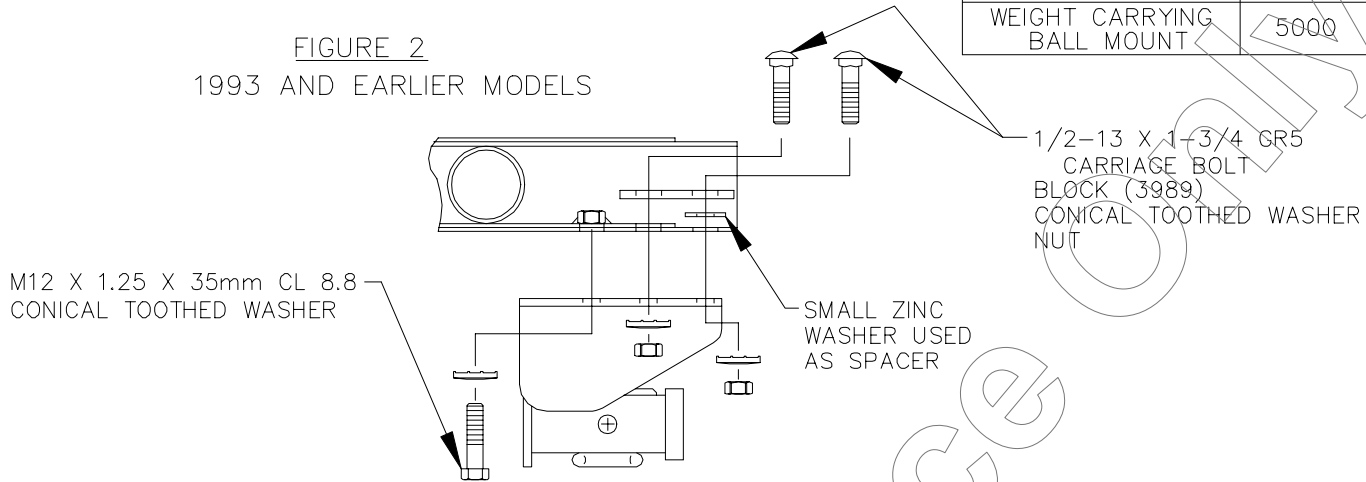

— EXHAUST MODIFICATIONS SHOULD BE MADE BY QUALIFIED FACILITY. —
NOTE: EITHER MODIFICATION WILL PROVIDE THE NECESSARY CLEARANCE.

SIDE VIEW

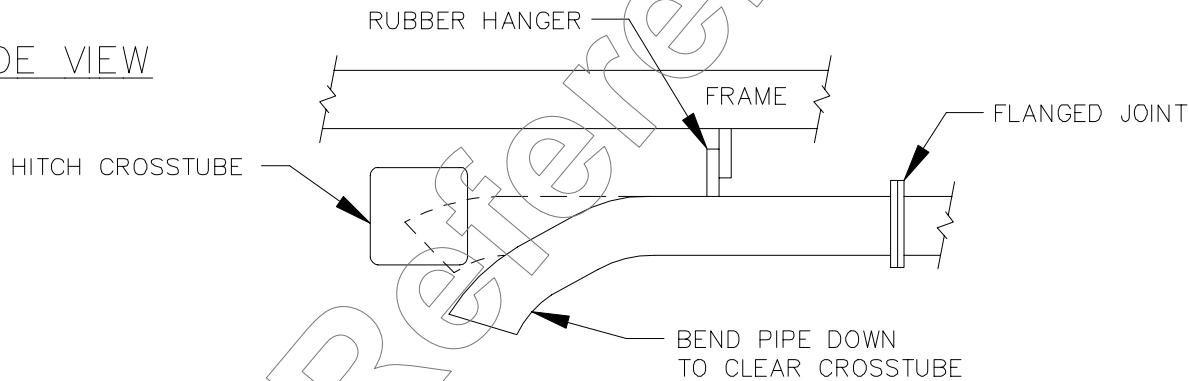

TOP VIEW

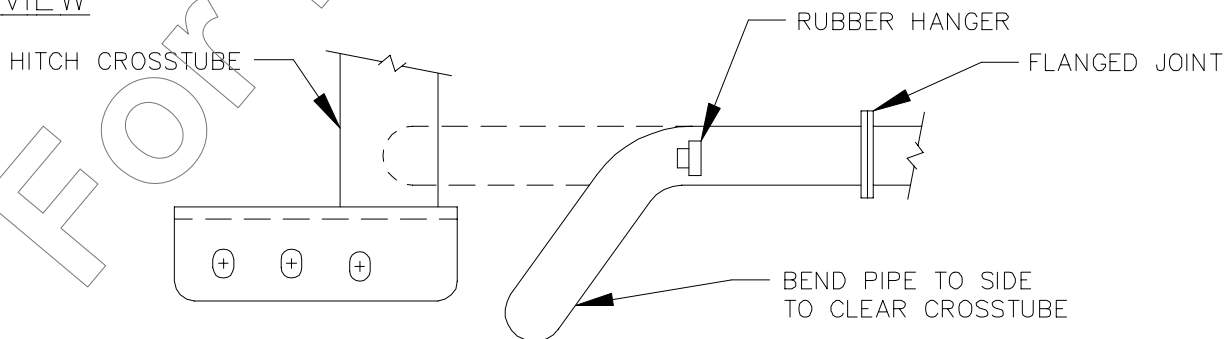

THIS PRODUCT COMPLIES WITH SAFETY SPECIFICATIONS AND REQUIREMENTS FOR CONNECTING DEVICES AND TOWING SYSTEMS OF THE STATE OF NEW YORK AND V.E.S.C. REGULATION V-5.

APPROX WEIGHT (LB.)

32

FASTENER KIT NO.

1131-079

NOTE: Check hitch frequently, making sure all fasteners and ball are properly tightened. If hitch is removed, plug all holes in trunk pan or other body panels to prevent entry of water and exhaust fumes. A hitch or ball which has been damaged should be removed and replaced. Observe safety precautions when working beneath a vehicle and wear eye protection. Follow car maker's specs for maximum trailer weight and tongue weight. Do not cut access or attachment holes with a torch.



Canton, Michigan