

No-Drill System

No drilling into your vehicle fender required!

2014 CHEV Rear Mud Flap Set, 5/8" Offset, Rear Mounting Diagram & Instructions Part # 756791

IMPORTANT:

The manufacturer is not responsible for negligent use of vehicle with mud flaps installed, including over-tightening of screws and bolts causing damage to vehicle or mud flaps.

TOOLS REQUIRED:

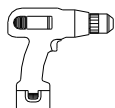

*Electric or Chargeable
1/2" or 3/8" drill*



3/8" Socket Driver

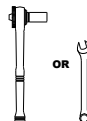

*7/16" Open Wrench
or Socket Wrench*



*#15 Torque
Screwdriver*

KIT CONTAINS: PARTS BAG #750580

*a) (1) Flap Assembly,
Rear, PS*

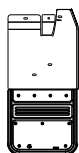

*b) (1) Flap Assembly
Rear, DS*



*c) (2) Screw, TEK
1/4" x 1.25"
Part #010011*



*d) (4) Flat Washer
0.281" x 1.0"
Part #018028*



*e) (2) Capscrew, SS
1/4" x 1"
Part #014007*



*f) (1) Mount Clip, DS
w/ Clinch Nut
Part #750582*

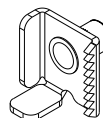

*g) (1) Mount Clip, PS
w/ Clinch Nut
Part #750584*

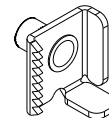

INSTALLATION: (For ease of installation, it is suggested that the wheel be removed)

1. Before you install your Mud Flap Set, see the Diagram and parts list for all necessary parts. Cut protective plastic and peel away from the stainless steel. Start on the Driver's Side.
2. Install the mud flap clip to the hole #1 with a capscrew and a flat washer then tighten the screw until the bottom tab of the mud flap clip just passes through the bottom slotted hole of hole #1.
3. Remove the two (2) factory screws on the wheel well and one (1) factory screw on the wheel tub as shown on the diagram and reinstall these three (3) factory screws on holes #2, #3 and #5 through the factory holes #6 to #8, loosely secure at this point. Ensure that the installed mud flap clip is behind the factory wheel well.
4. Square the flap with the tire while putting pressure against the wheel well and tighten the three (3) factory screws on holes #2, #3 and #5.

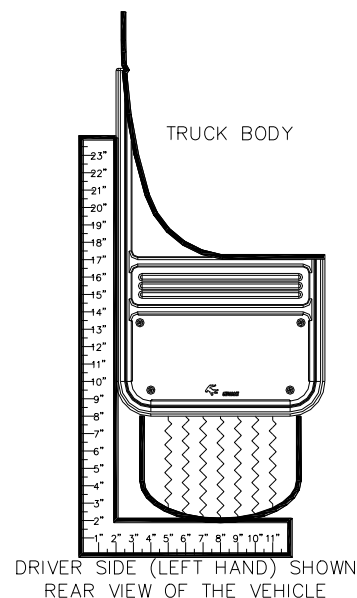

5. Now secure the flap with a flat washer and a tek screw on hole #4 through the wheel tub
6. Secure the upper tab of the mud flap by sliding the installed mud flap clip on hole #1 to the wheel well until the mud flap clip's teeth are gripped tight behind the wheel well and then tighten the screw.
7. Repeat the procedure for the passenger side.

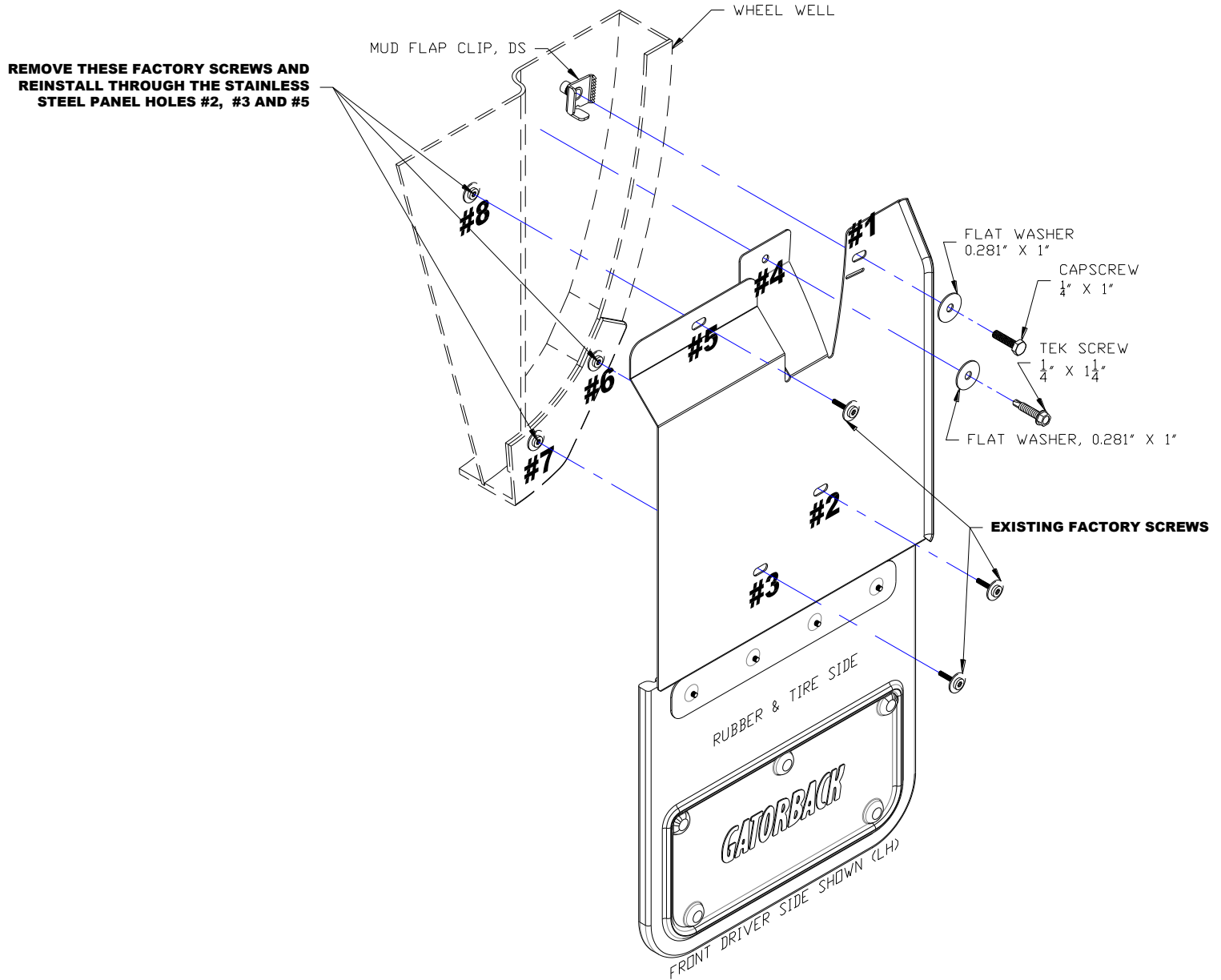

IMPORTANT

Manufacturer is not responsible for negligent use of vehicle with Mud Flaps installed, or over tightening of screws and bolts causing damage to vehicle or mud flaps.