



# 2021-2022 Ford Bronco

## Mud Flap Set, Front

### Mounting Diagram & Instructions

For use with vehicles without running boards  
Not recommended for base models with 30" tires  
**GCN406F**

#### IMPORTANT:

Manufacturer is not responsible for negligent use of vehicle with mud flaps installed, including over-tightening of screws and bolts causing damage to vehicle or mud flaps.

#### TOOLS REQUIRED-



#2 Phillips Bit  
Or Screwdriver

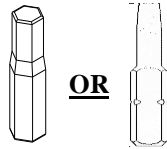

T25 Torque Socket  
or 5/32" Allen Socket



18mm Socket

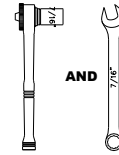

7/16" Open Wrench  
and Socket Wrench

#### FLAPS/BRACKETS/LOCKING CAPS

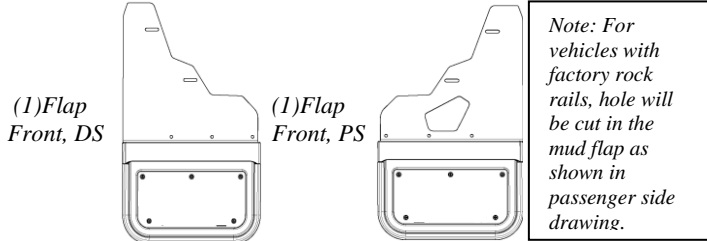

(1) Flap  
Front, DS

(1) Flap  
Front, PS

Note: For vehicles with factory rock rails, hole will be cut in the mud flap as shown in passenger side drawing.

Please note: There will be a plastic piece in the upper mount channel. Please remove and discard.



(1) Locking Cap  
DS  
Part #080642

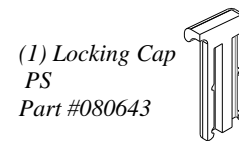

(1) Locking Cap  
PS  
Part #080643



(2) Z Bracket  
Front, Universal  
Part #770241



(1) Mounting Brkt  
Front, DS  
Part #770239

(1) Mounting Brkt  
Front, PS  
Part #770240

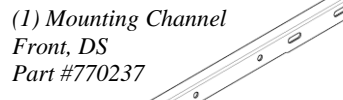

(1) Mounting Channel  
Front, DS  
Part #770237



(1) Mounting Channel  
Front, PS  
Part #770238

#### PARTS BAG # 770278

a) (12) Button Hd. Screw  
1/4"-20 x 3/4", SS, Blk Ox.  
Part #014081



b) (2) Button Hd. Screw  
1/4"-20 x 2", SS, Blk Ox.  
Part #014083



c) (4) Capscrew, SS Blk Ox.  
1/4"-20UNC x 3/4"  
Part #014070



d) (4) Washer, Flat,  
1/4" x 1" OD, SS, Blk Ox.  
Part #018069

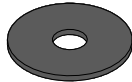

e) (20) Washer, Nylon  
1/4" x 5/8" Blk  
Part #054071



f) (2) Washer, Offset  
0.281" x 1.5" SS, Blk Ox.  
Part #018087



g) (2) Spacer, Nylon, Blk  
1/4" x 1/2" x 7/8"  
Part #054082



h) (12) Hex Nut  
1/4"-20, SS, Blk Ox.  
Part #025038



i) (12) Washer, lock  
1/4" Helicoil, SS, Blk Ox.  
Part #024012



j) (6) Spring Nut  
1/4"-20UNC, 0.84" Reach  
Part #028011



k) (4) Hex Bolt  
M 12 x 25mm, SS  
Part #014079  
Only used on vehicles without  
crash bar extension.

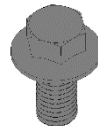

l) (4) Flange Nut  
SS, M 12, Serrated  
Part #025039  
Only used on vehicles with  
crash bar extension.

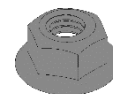

# INSTALLATION *(For ease of installation it is suggested that the wheel be removed)*

1. Before you install your mud flap and bracket set, see the diagrams and parts list for all necessary parts. Start on the driver's side.
2. Secure the mounting channel assembly through holes #4 to #6 to the mud flap through holes #1 to #3 using a screw (a) and secure with a nylon washer (e), lock washer (i) and hex nut (h). (See Diagram #1)

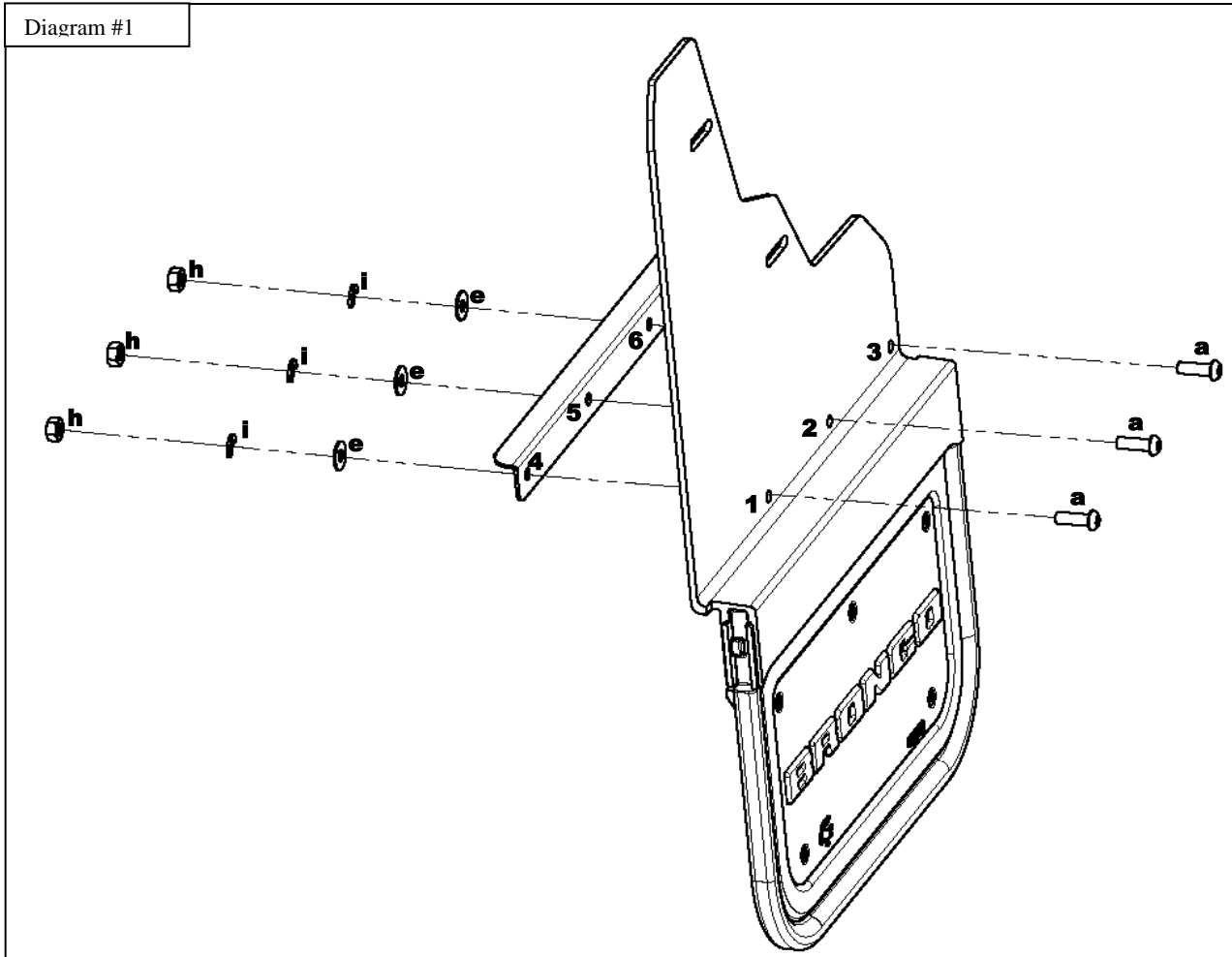

3. Secure the mounting bracket through holes #7 & #8 to the mounting channel through holes #9 & #10 using capscrew (c), and nylon washer (e), and secure with a nylon washer (e), lock washer (i), and hex nut (h). (See Diagram #2)

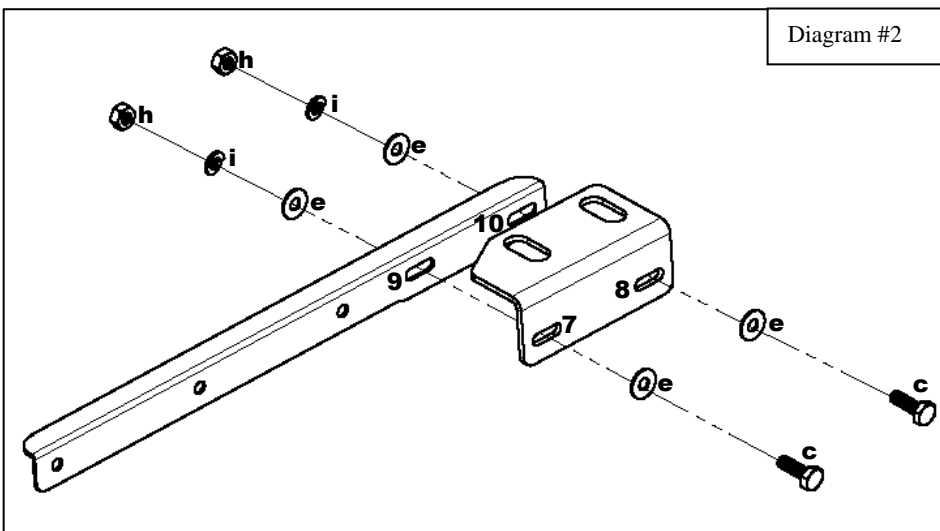

4. Loosely install mud flap hole #11 to Z-bracket hole #12 using a button head screw (a) and offset washer (d) and secure using a nylon washer (e), lock washer (i) and hex nut (h). (See Diagram #3)

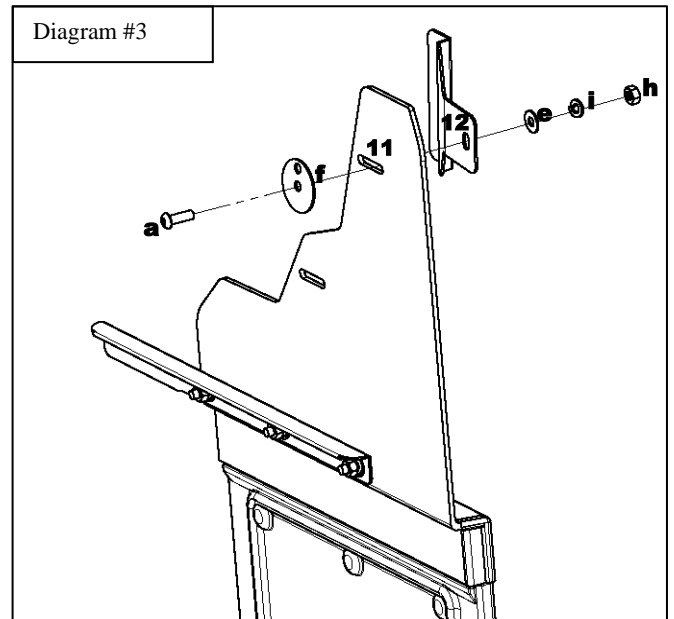

5. Remove the three lower factory push pins from holes #13 to #15 by unscrewing the center and then pulling the push pin out.
6. Lift the factory liner and install three spring nuts (j) over factory holes #13 to #15 (See Diagram #4)

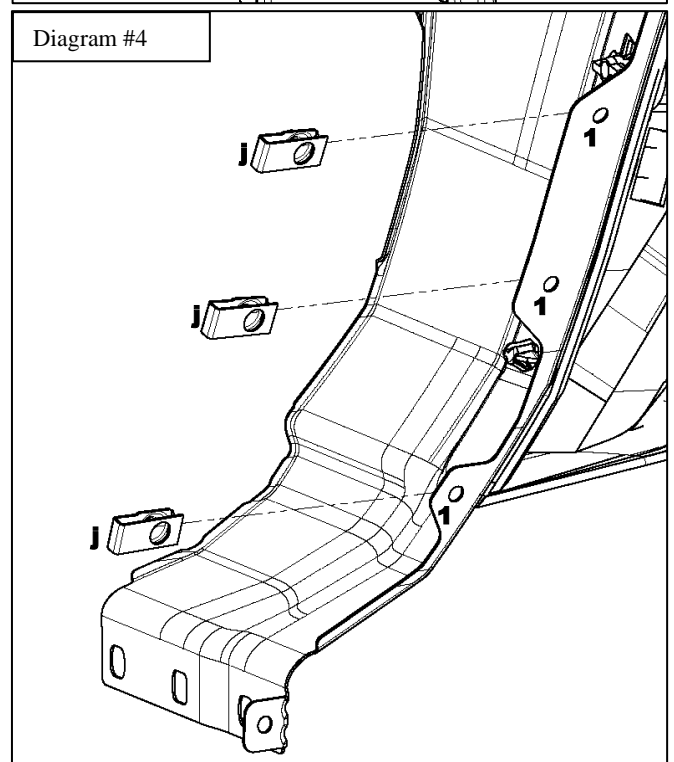

- 7a. For vehicles **with crash bar**, loosely install the mounting bracket through holes #16 & #17 to the factory crash bar mount bolts using an M12 serrated flange nut (l). (See Diagram #5a)

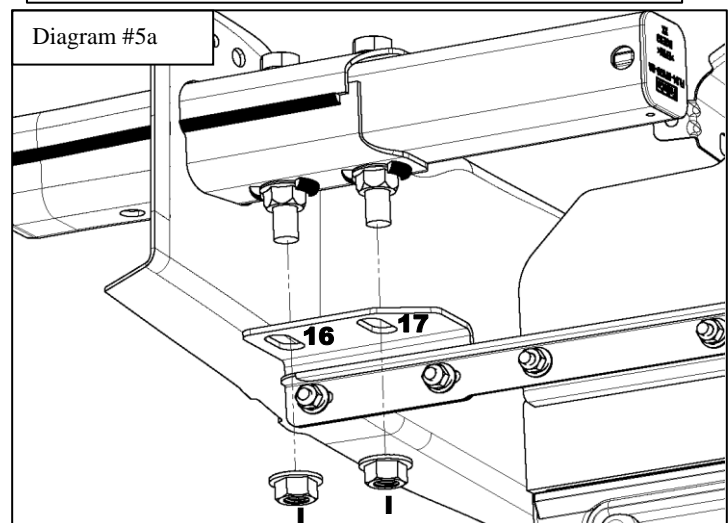

- 7b. For vehicles **without crash bar**, loosely install the mounting bracket through holes #16 & #17 to the factory crash bar mount holes #18 & #19 using an M12 bolt (k). (See Diagram #5b)

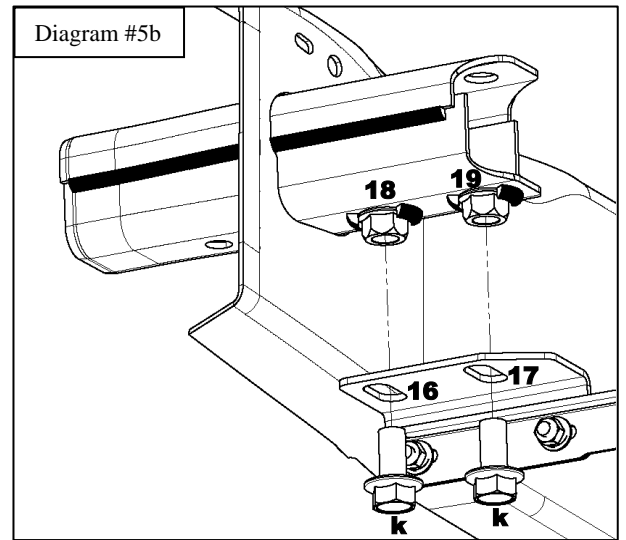

8. Loosely install mud flap through hole #20, flat washer (d), and spacer (g) into previously installed spring nut (j) on factory hole #15 using a button head screw (b) and flat washer (d). (See Diagram #6)

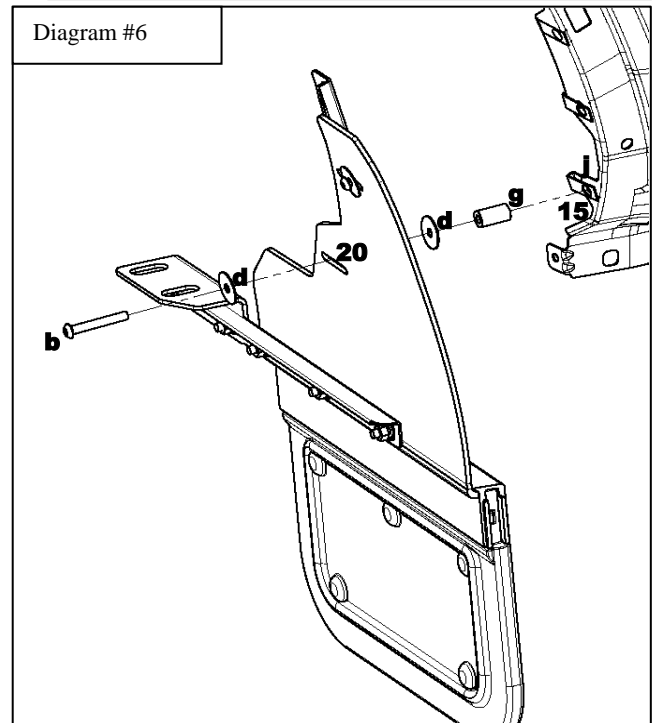

9. Install Z-bracket holes #21 & 22 to spring nuts (j) on holes #13 & #14 using button head screw (a) and nylon washer (e). (See Diagram #7)
10. With a square or other levelling tool, ensure that the flap is level.
11. Carefully tighten all fasteners, ensuring that the flap remains level.
12. Repeat procedure on the passenger side.

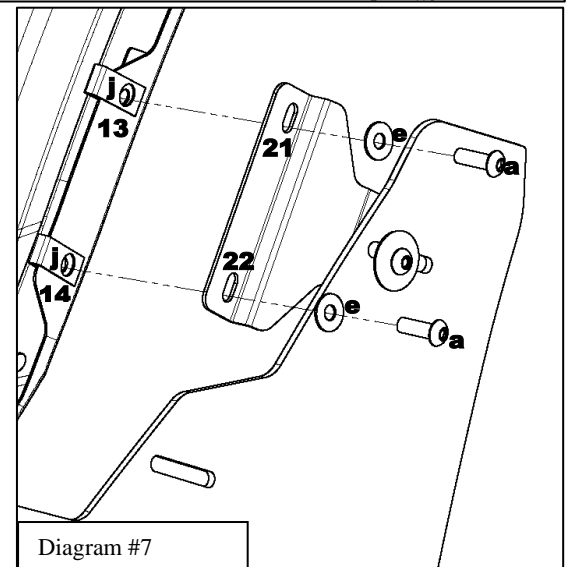

Please check out our YouTube channel to see an install video for this application

